

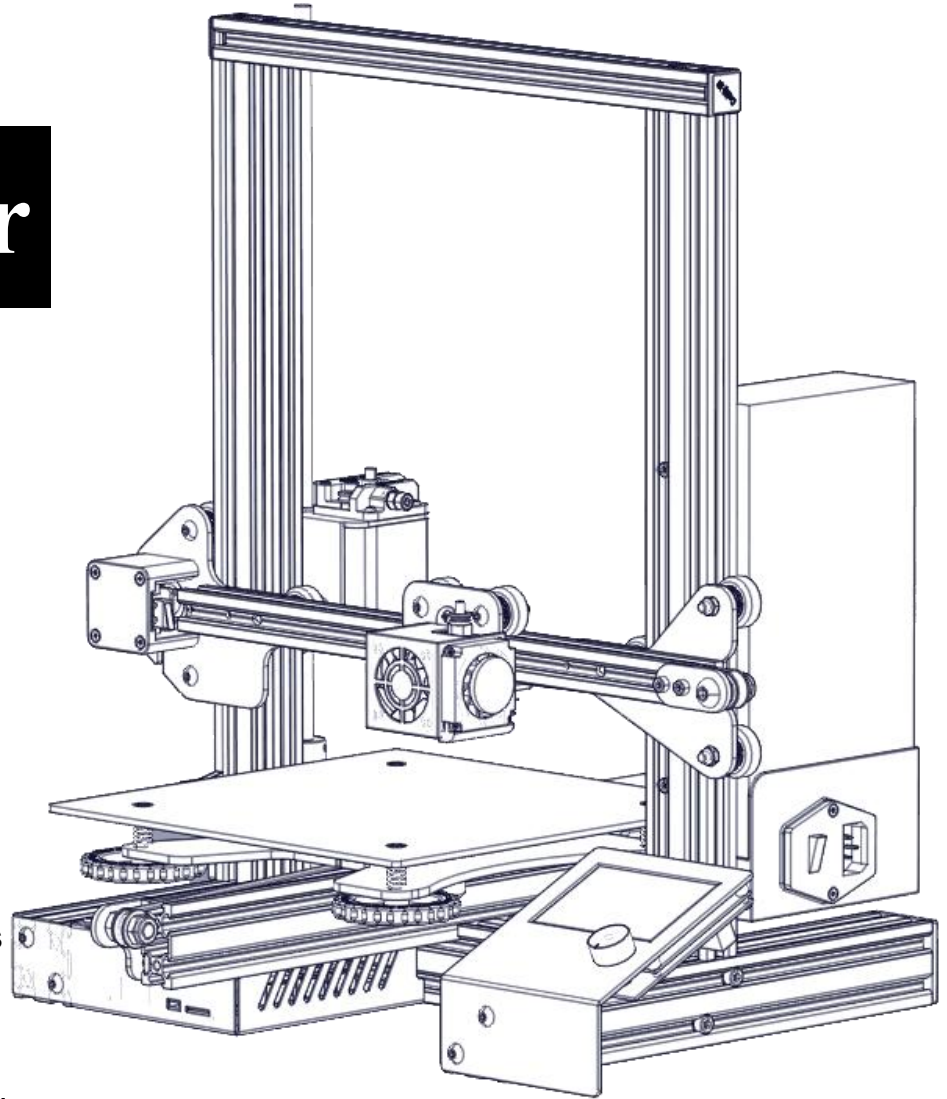

Ender 3 3D Printer

Instructions for assembly

- ◆ This guide is for the Ender 3 3D printer.
- ◆ Select the correct input voltage to match your local mains (220V or 110V)
- ◆ Because of software/hardware upgrades and model differences, new revisions may not be listed in this guide.
- ◆ Detailed instructions for use are available on the SD card.



List 1

Assemblys

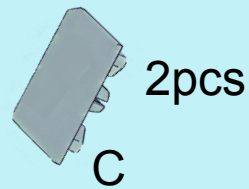
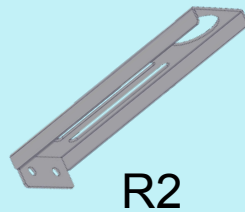
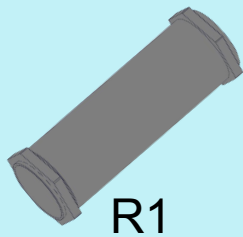
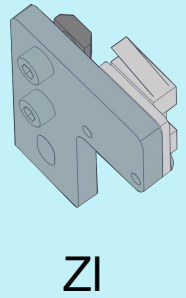
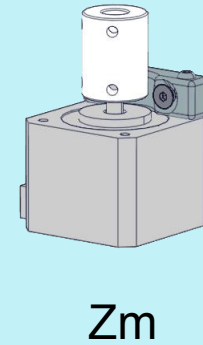
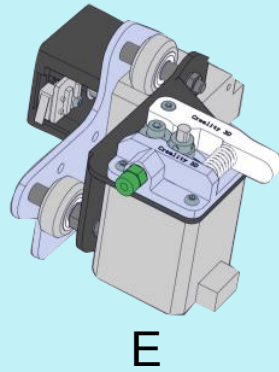
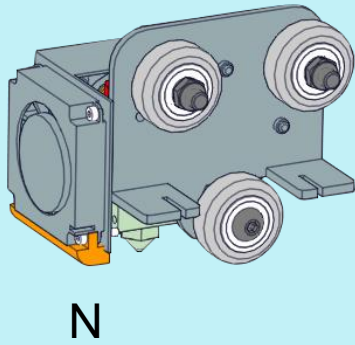
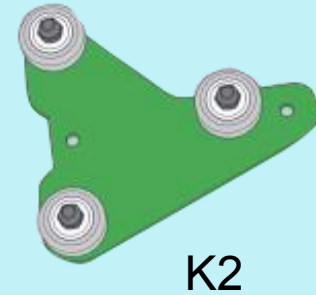
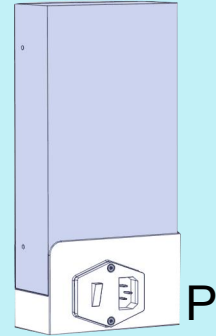
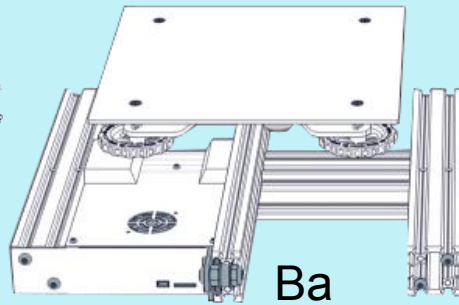
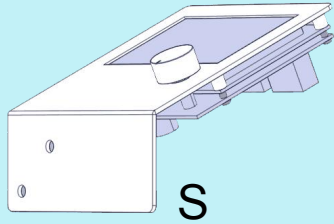

2pcs

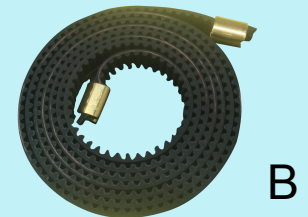
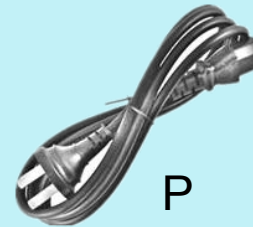

List 2

Sections

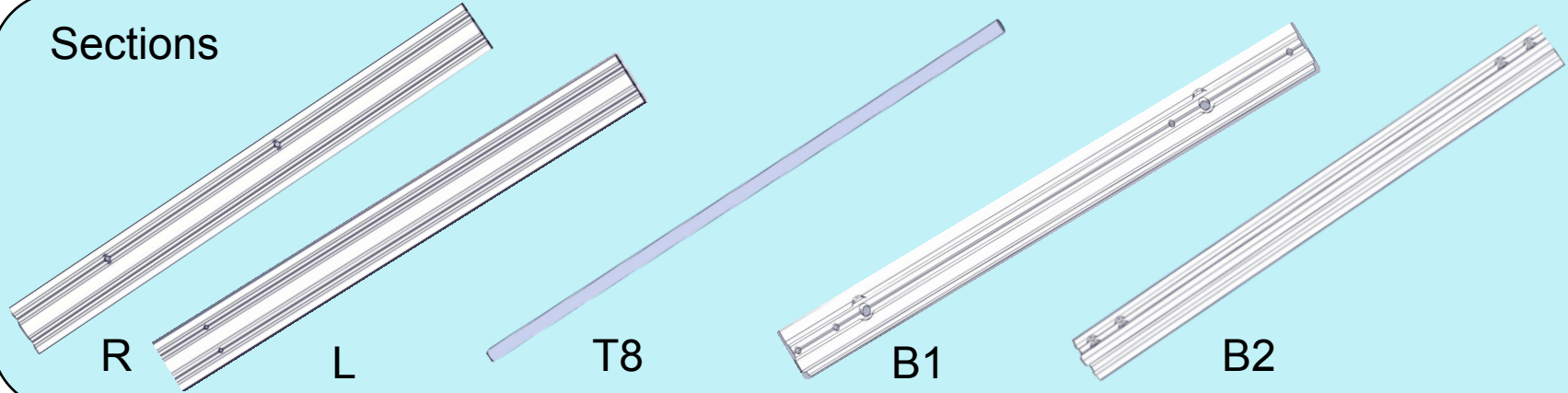

Fasteners

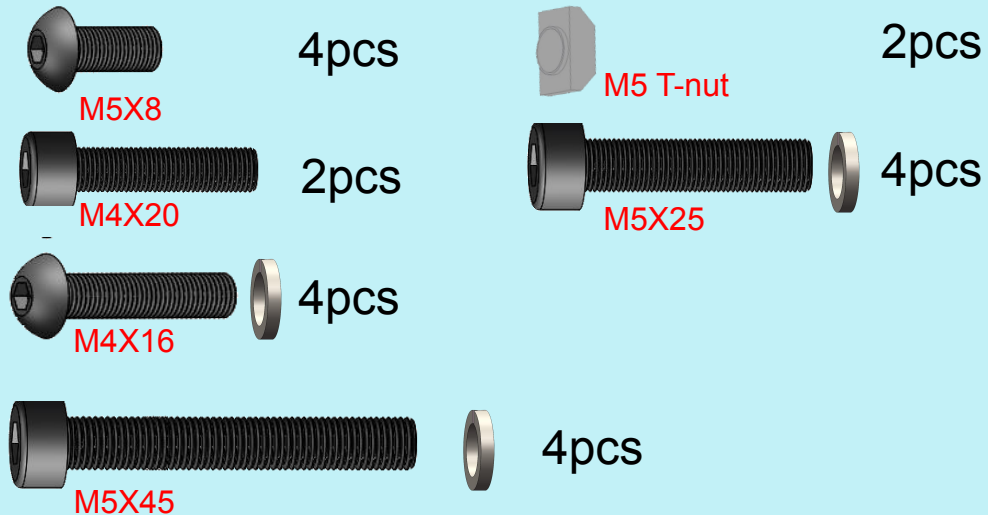

Tools



Step 1

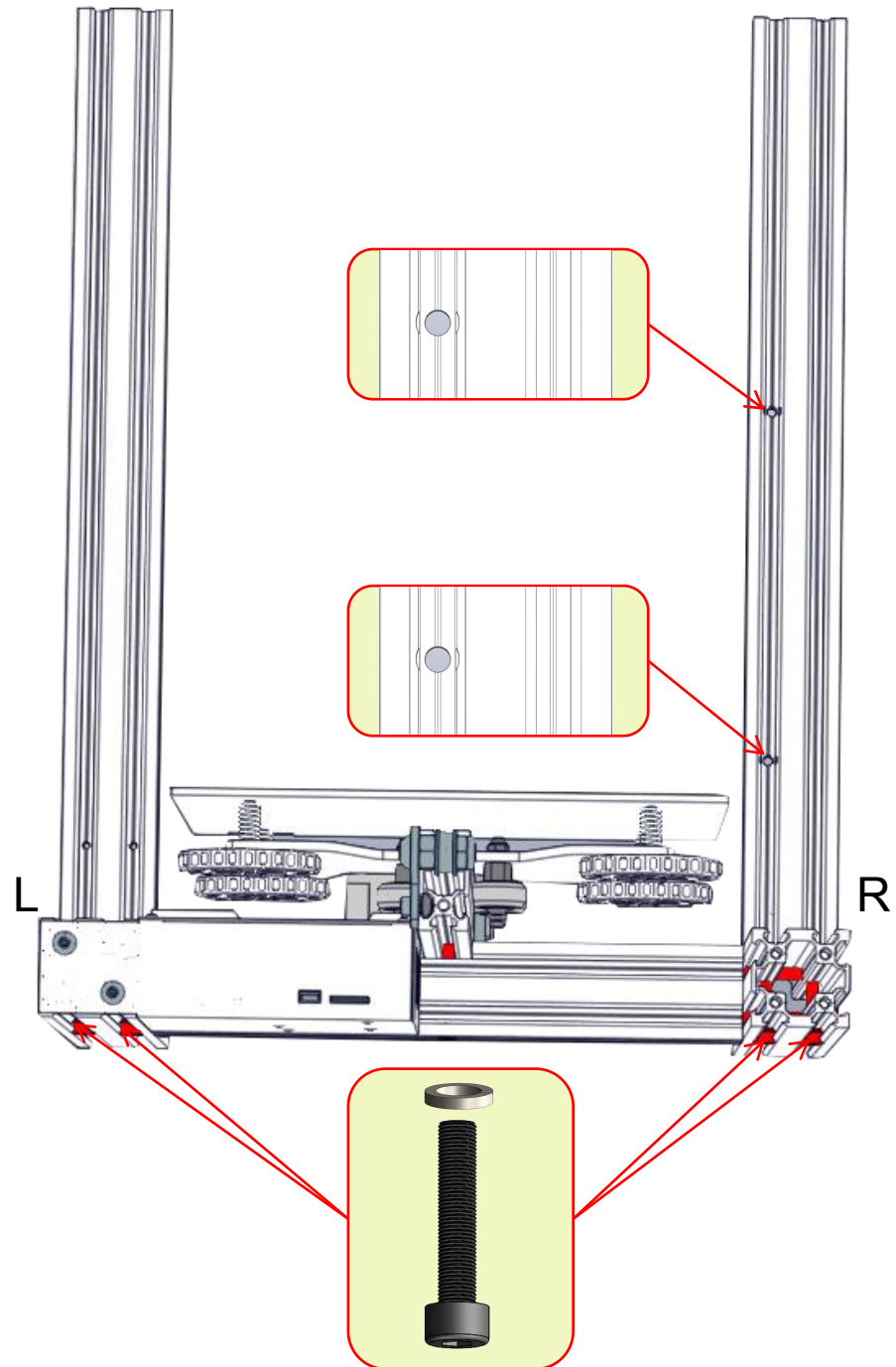
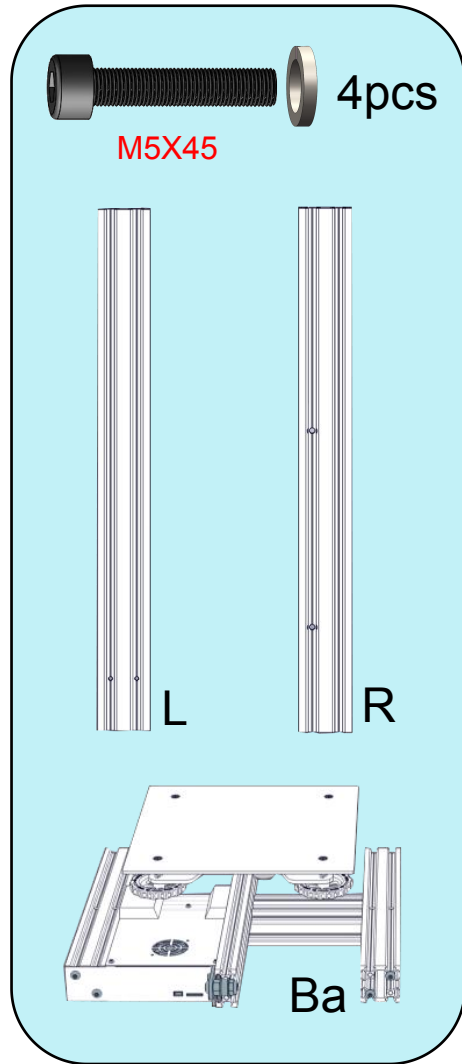

Step 2



2pcs

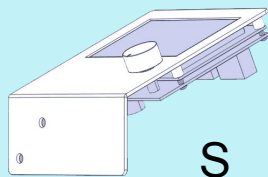

S



2pcs

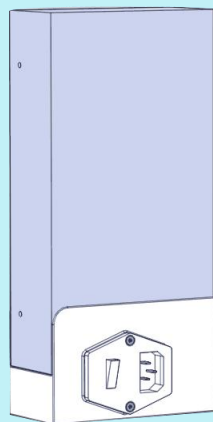

P

*Select the correct input voltage to match your local mains (220V or 110V).

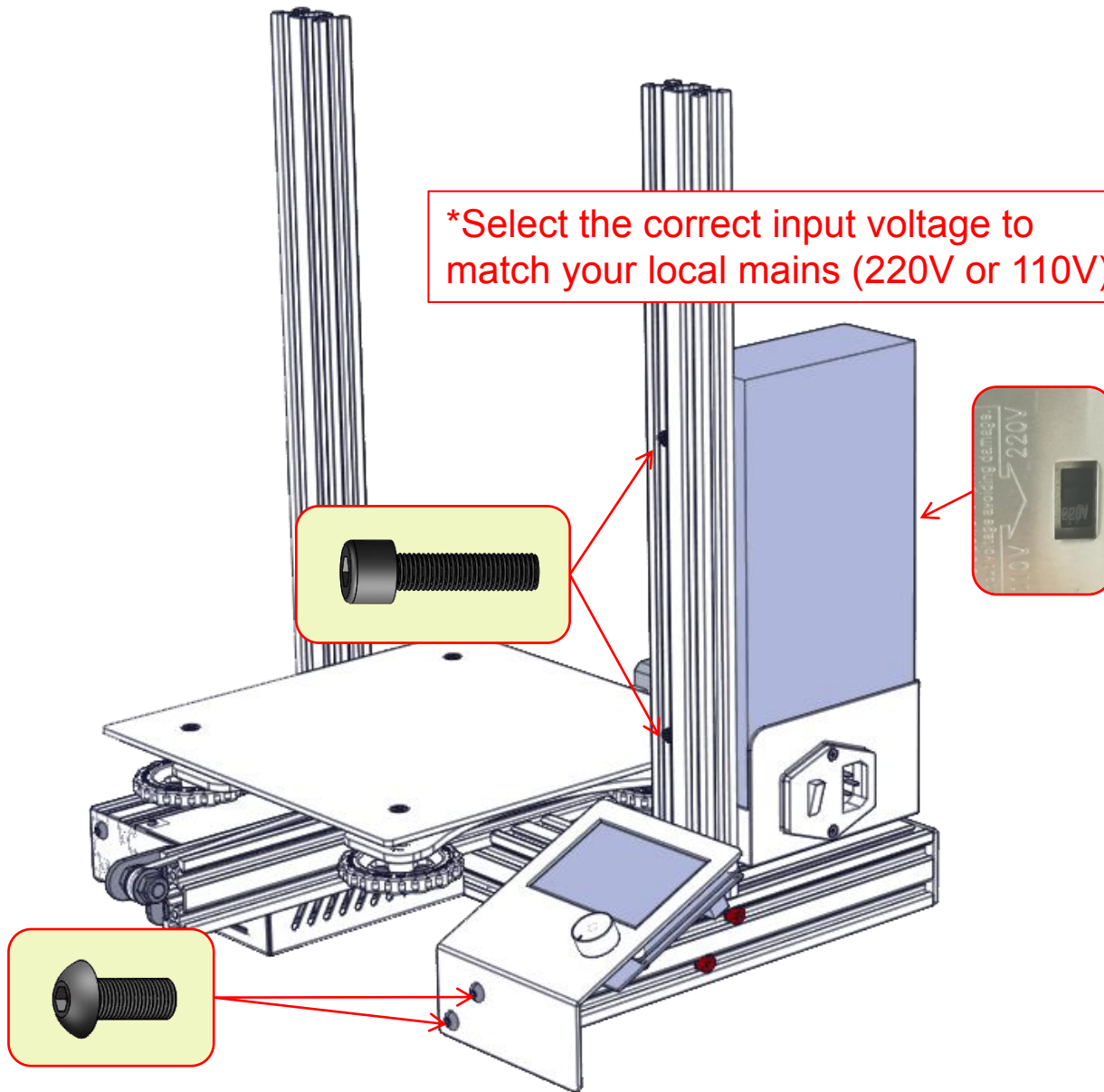

Step 3

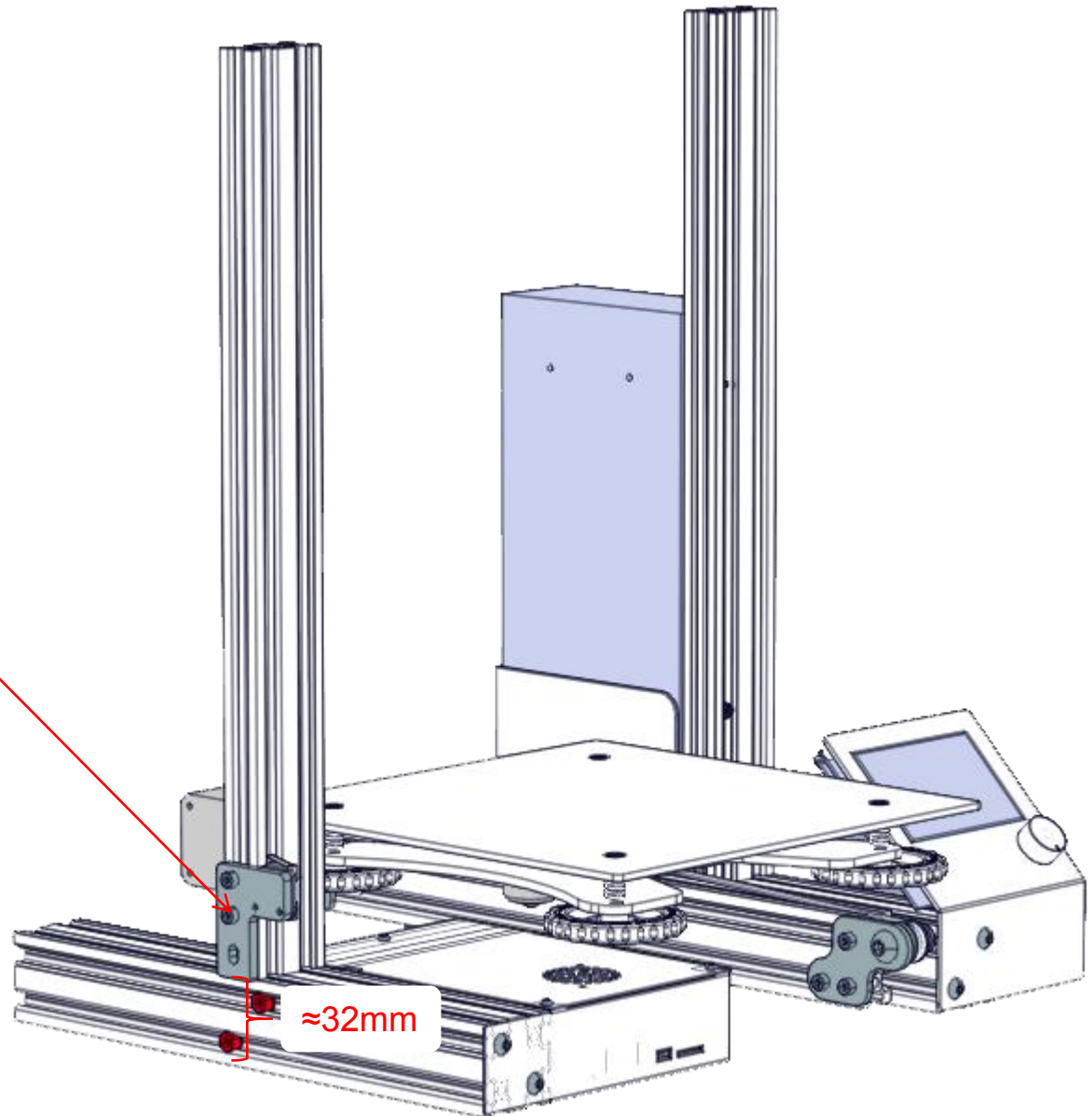
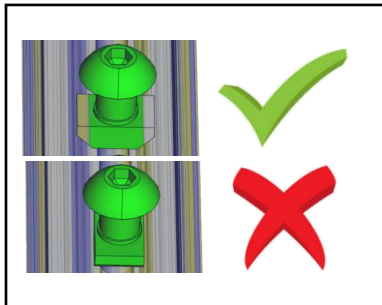
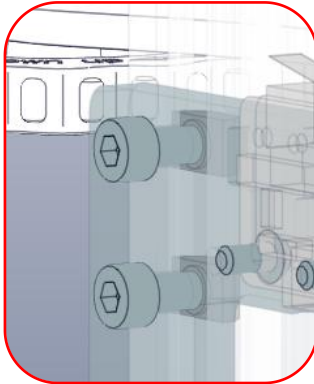
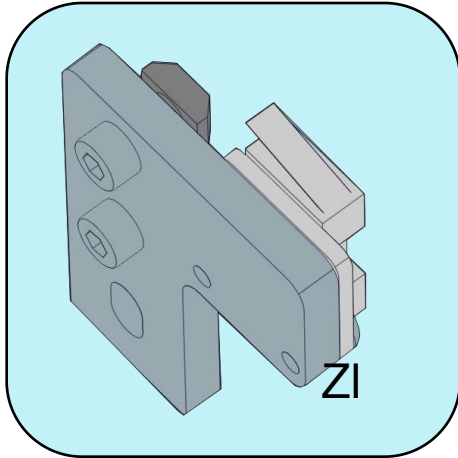

Step 4

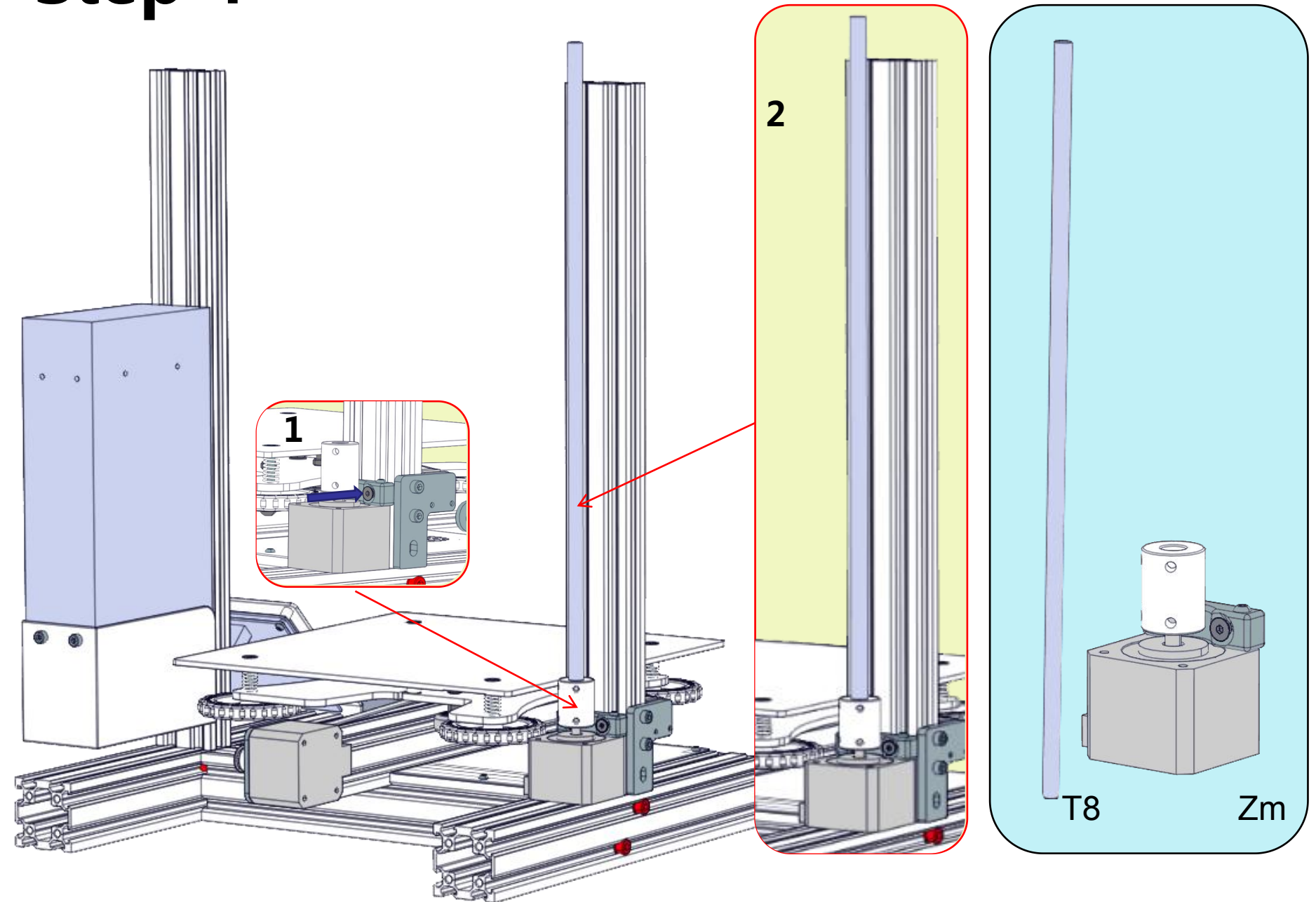

Step 5

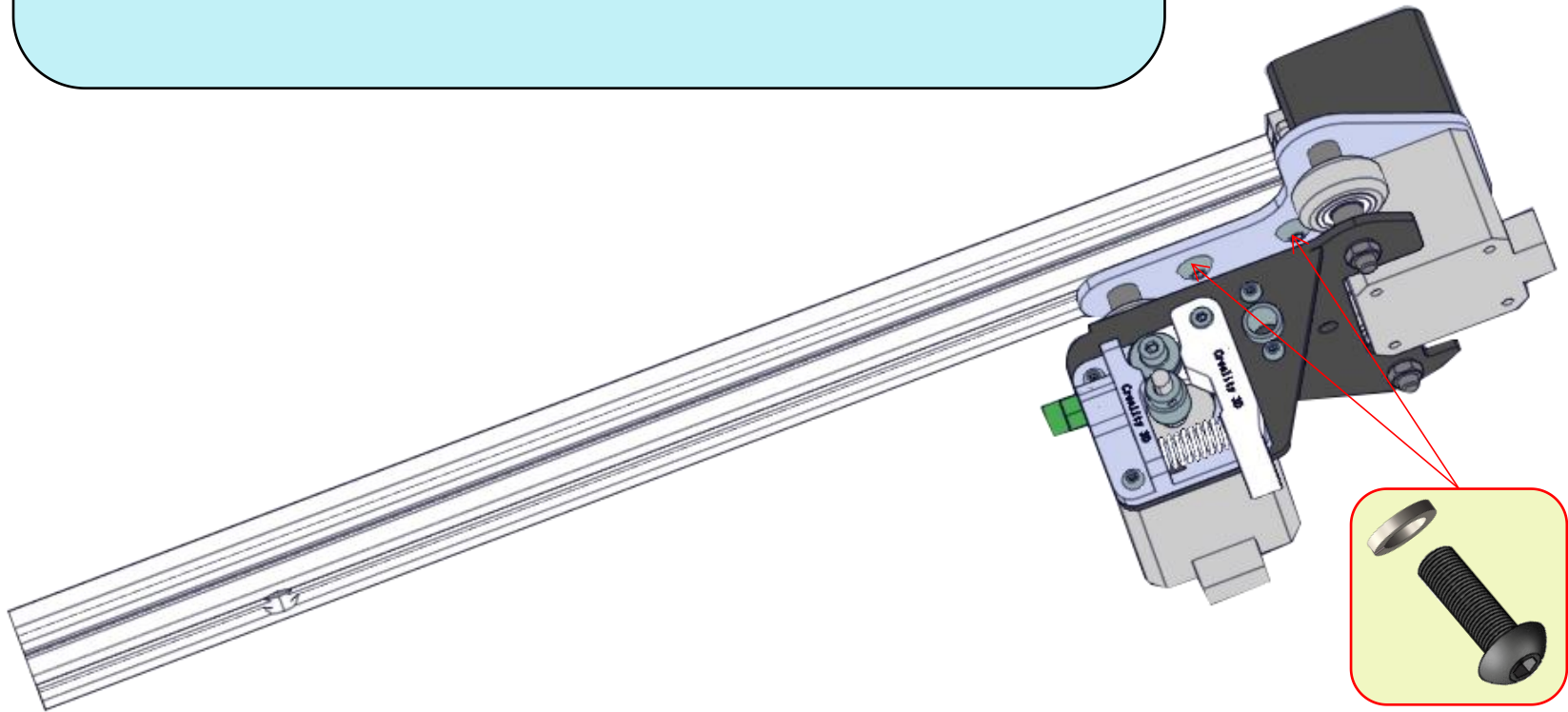
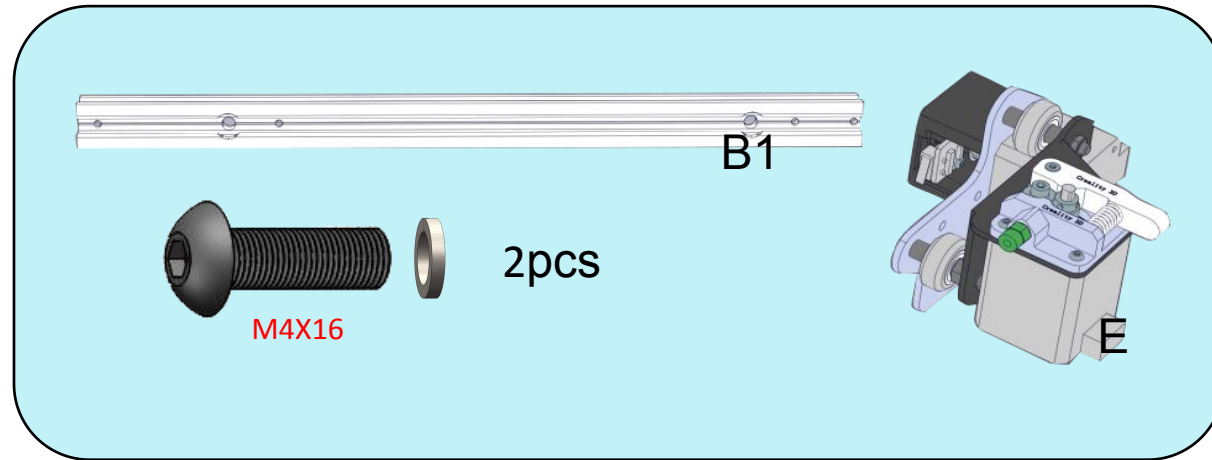

Step 6

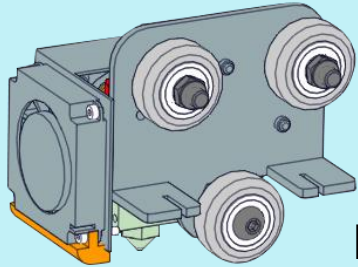

N

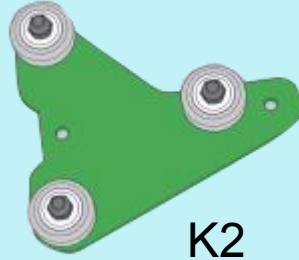

K2



M4X16

2pcs

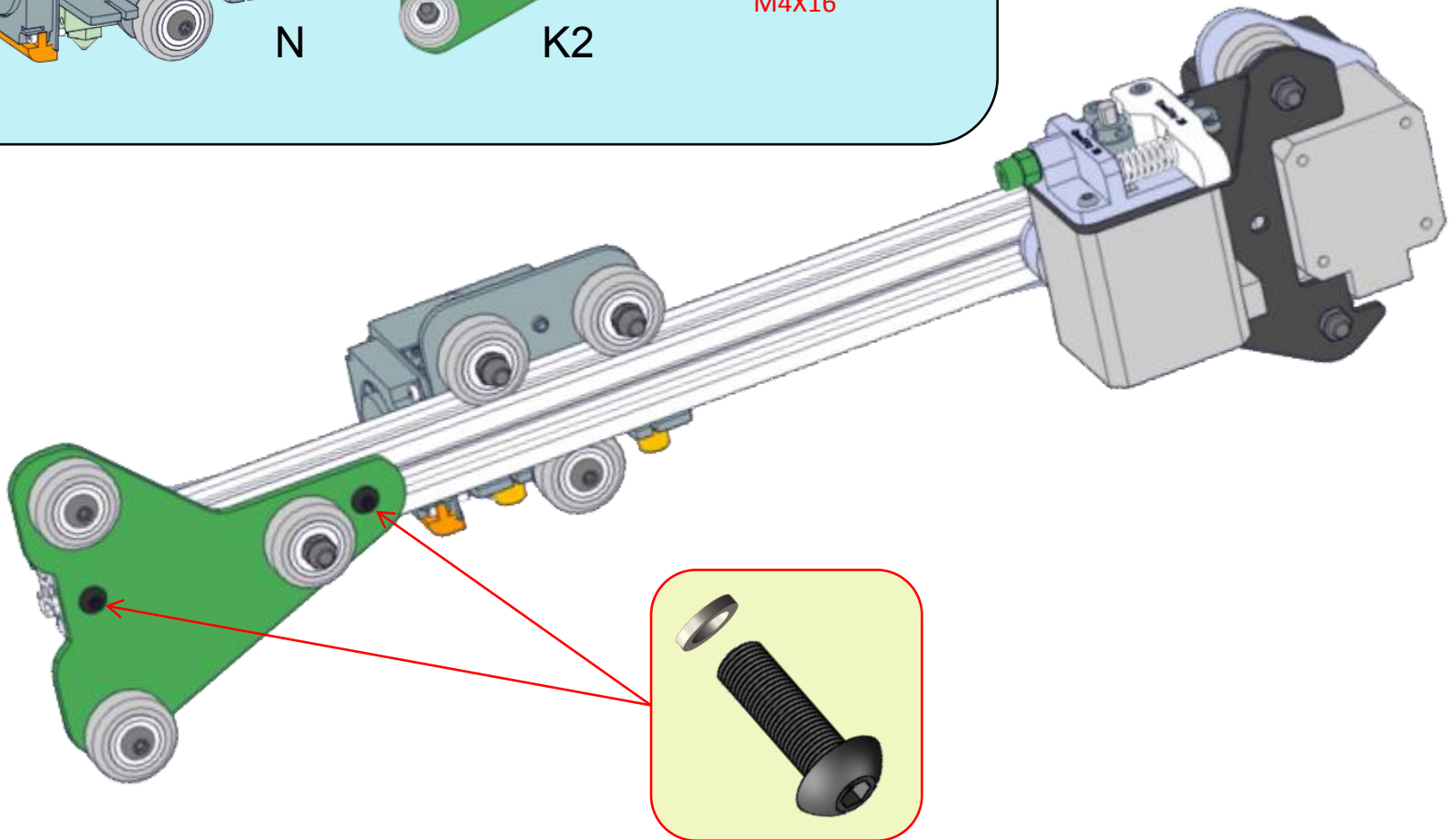

Step 7

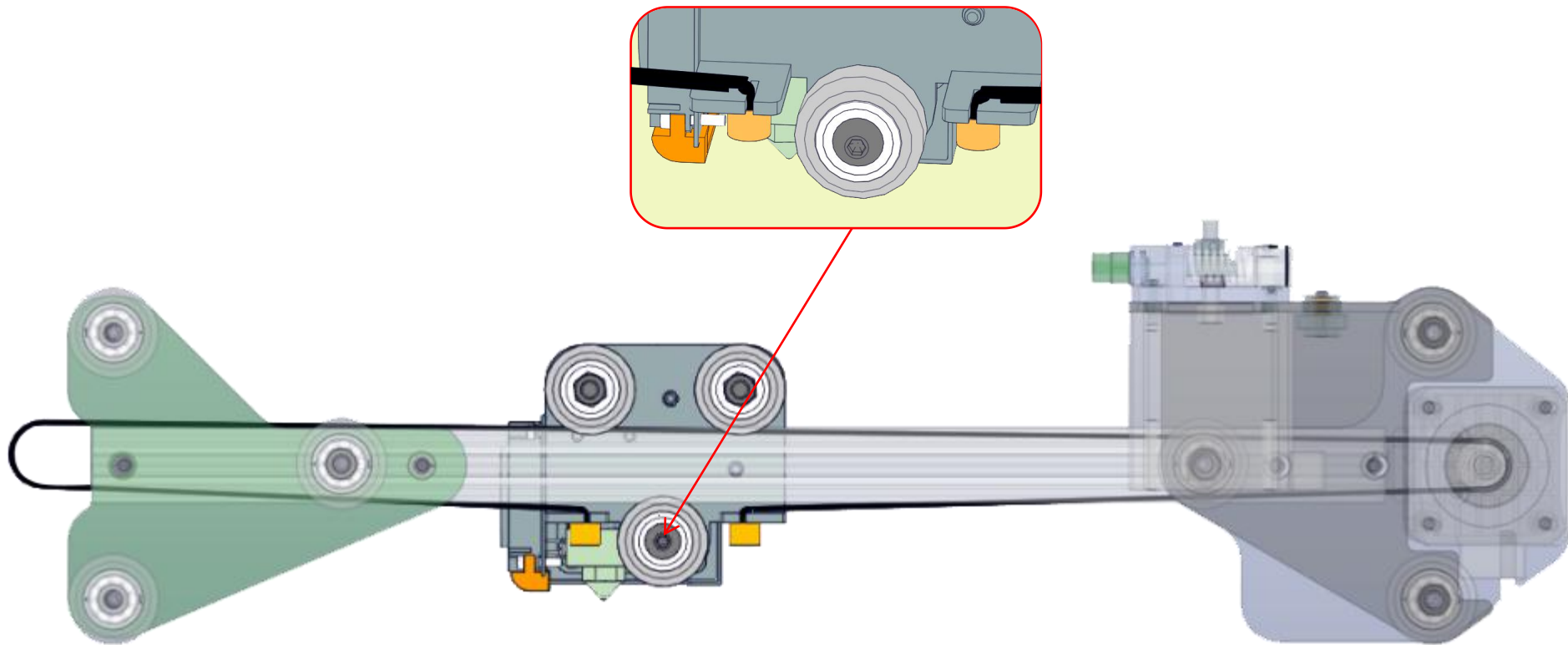
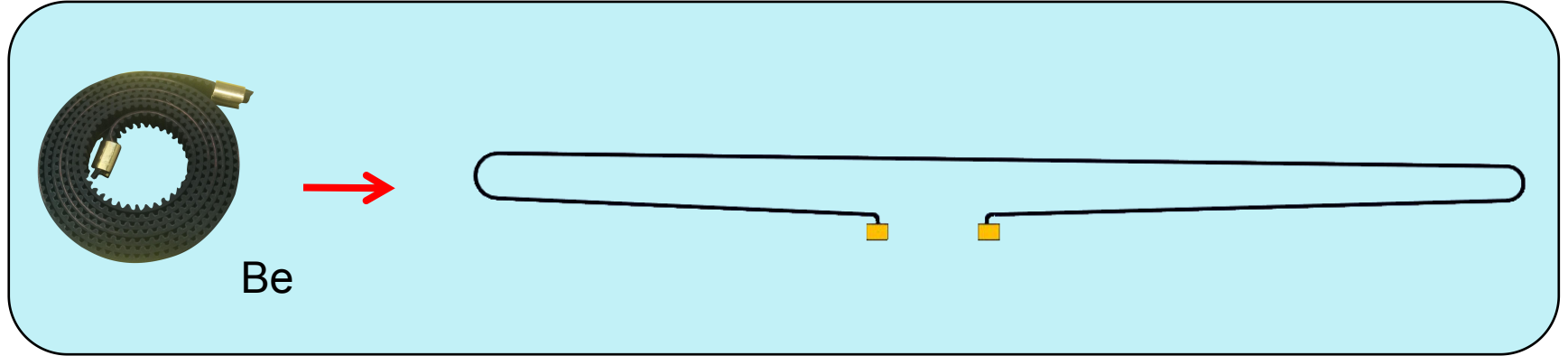

Step 8

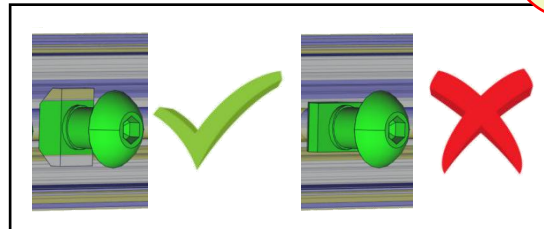
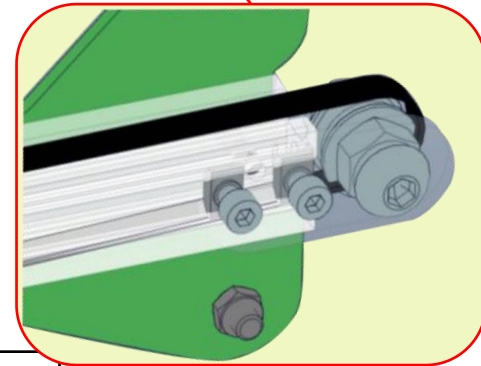
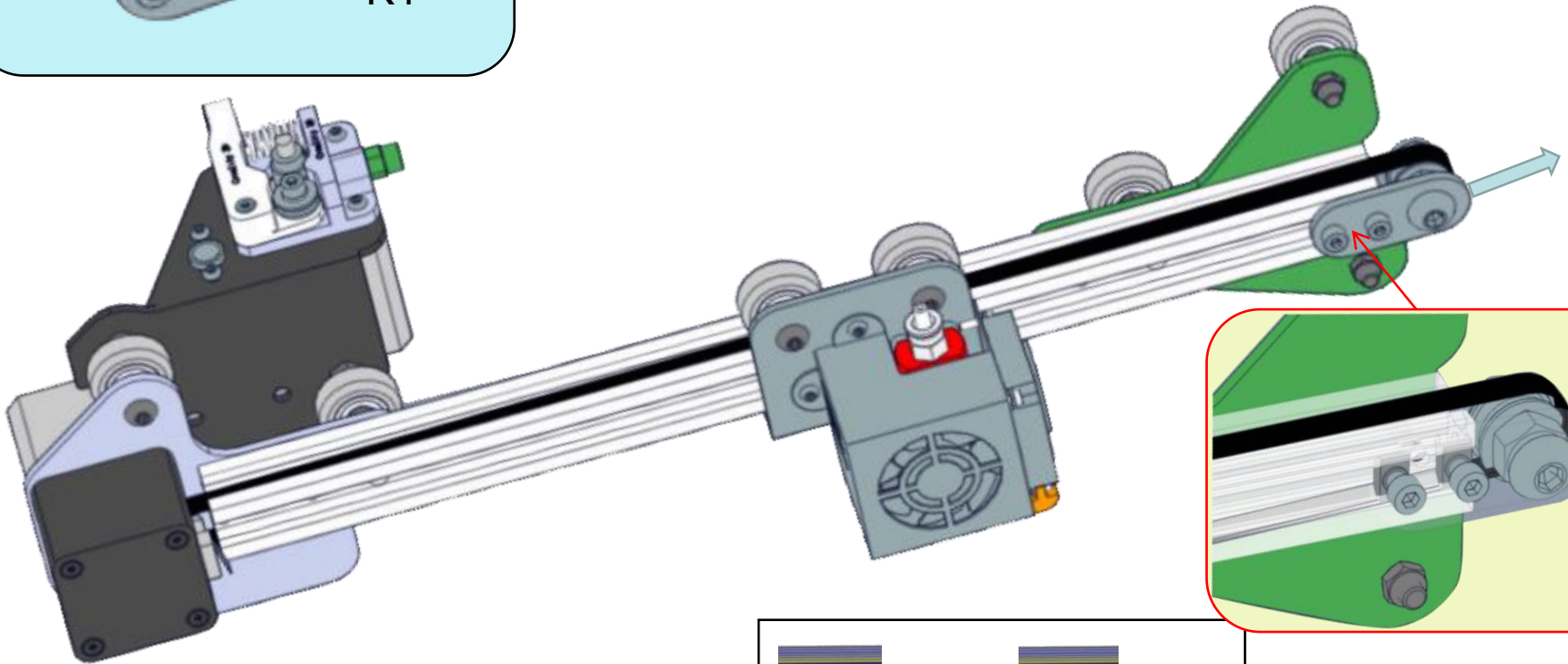
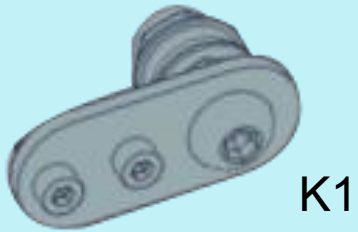

Step 9

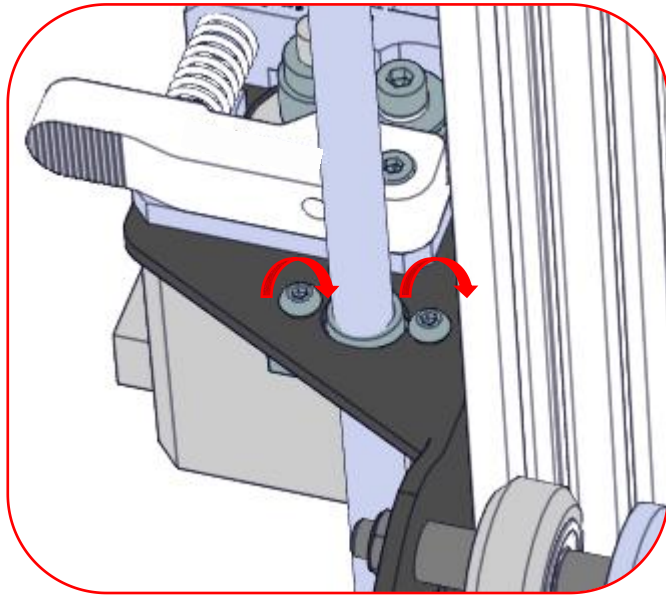
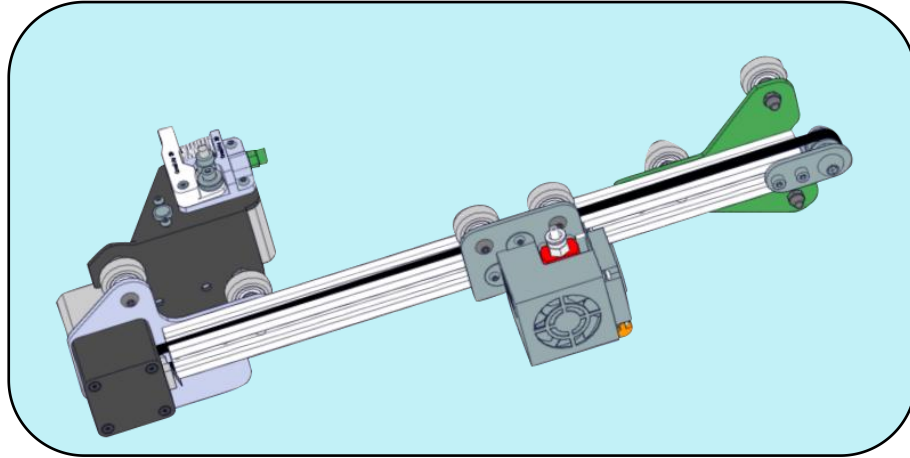

*Don't tighten it too tight

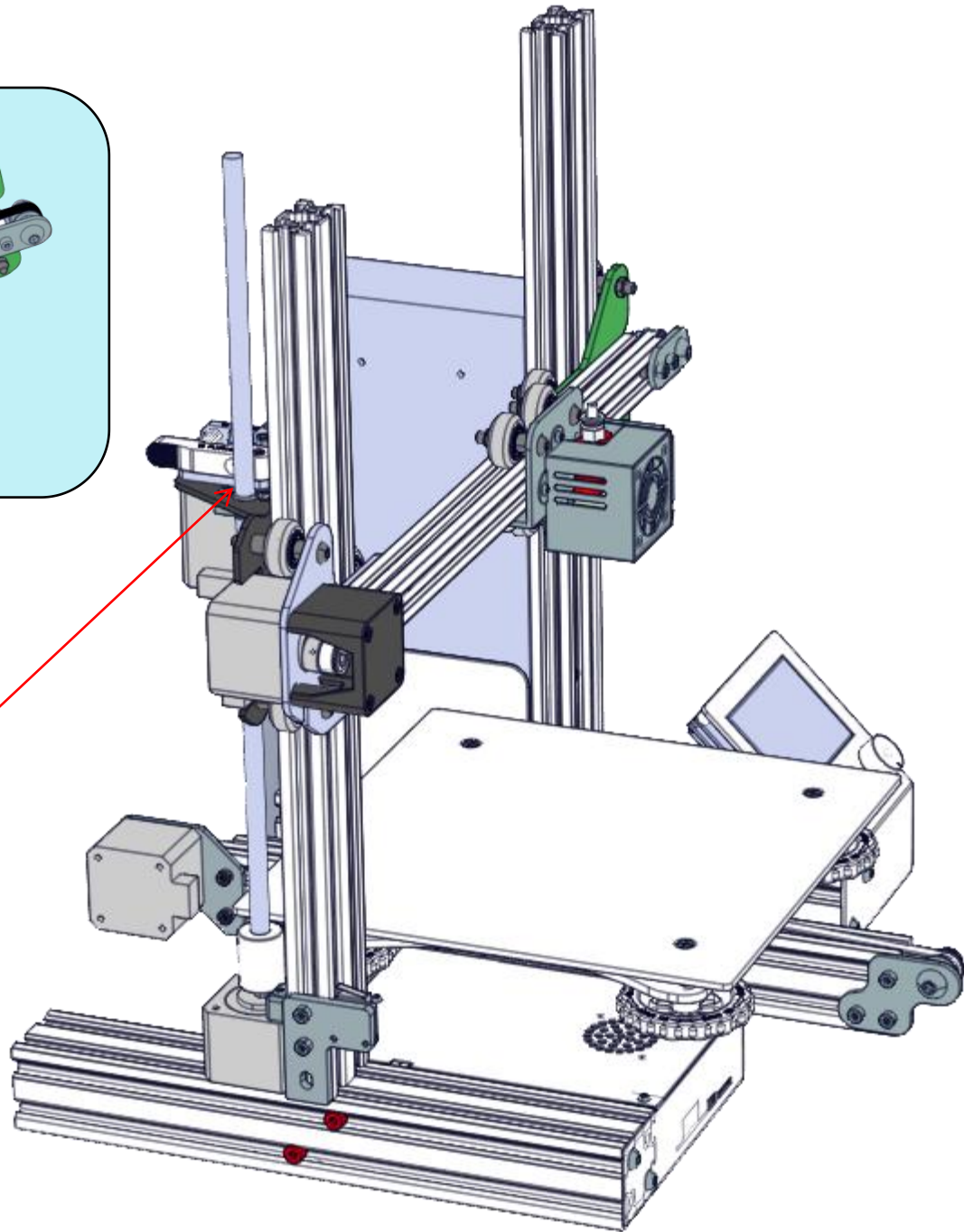

Step 10

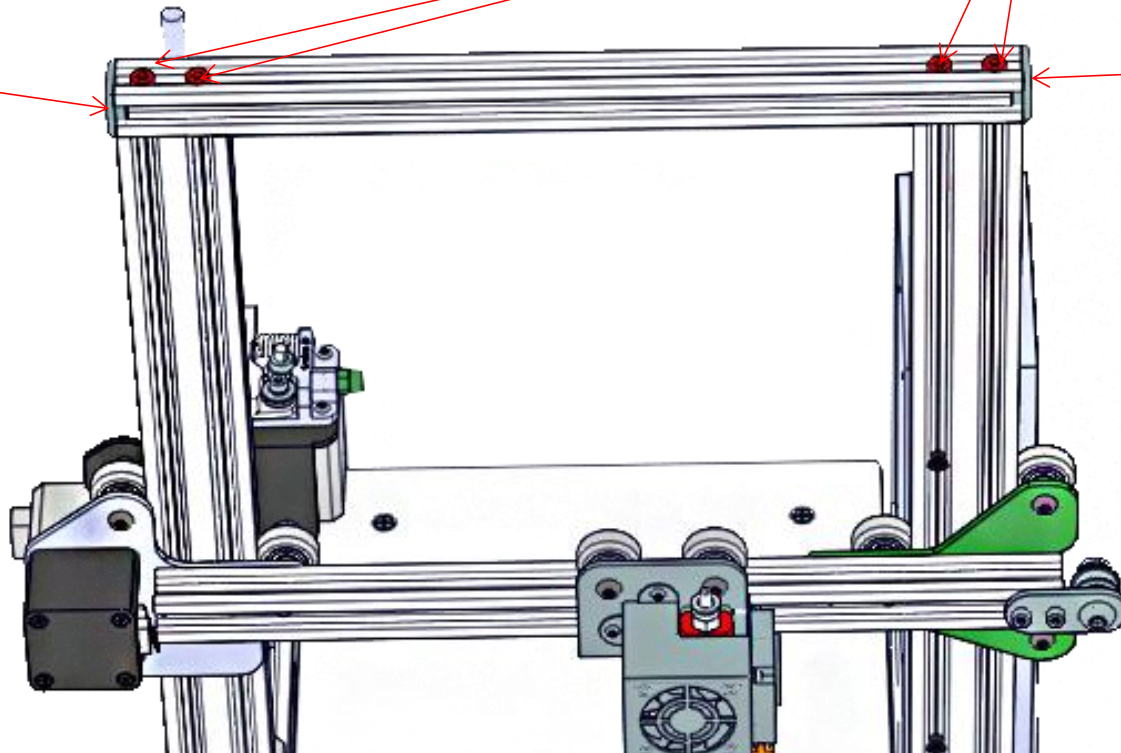
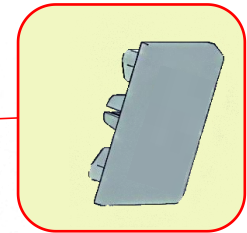
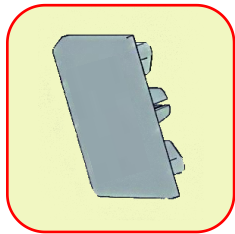
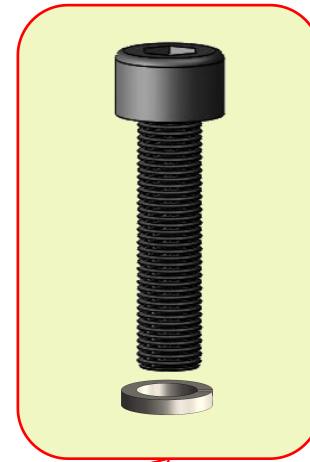
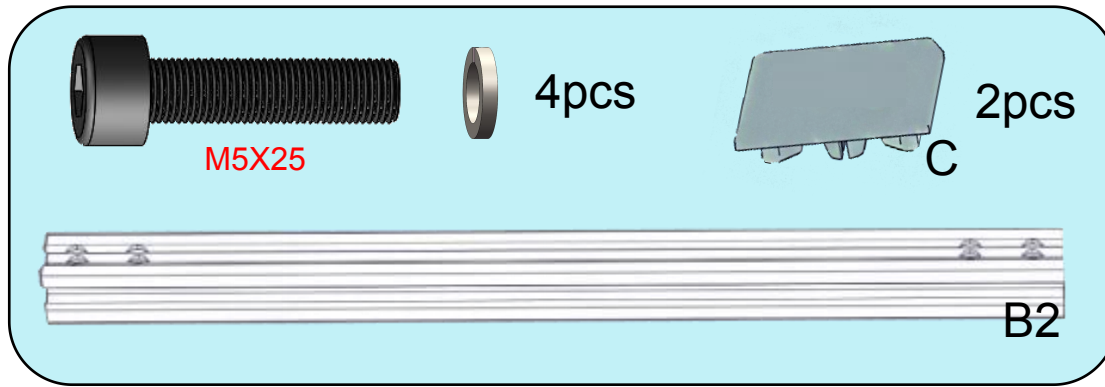

Step 11

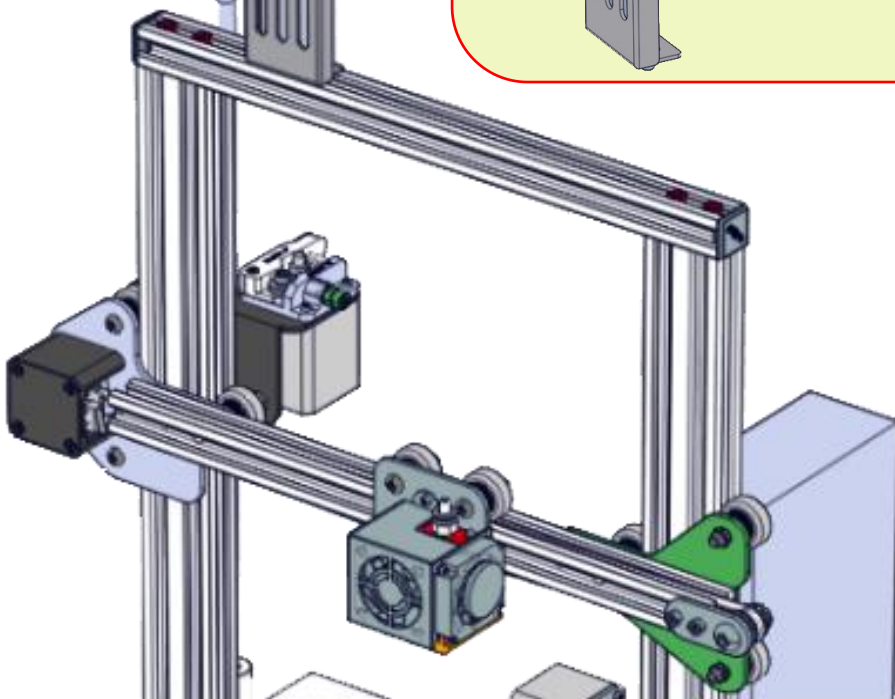
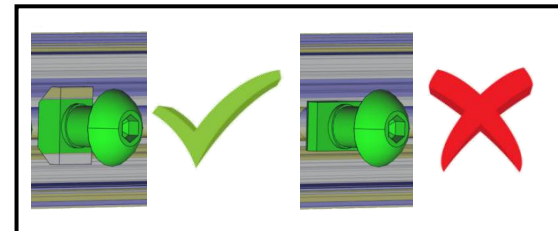
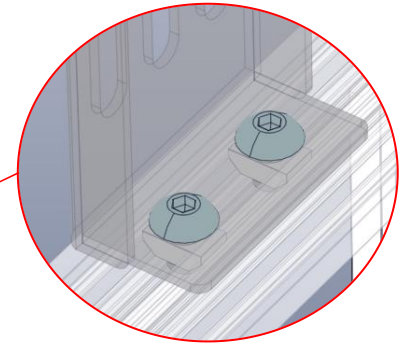
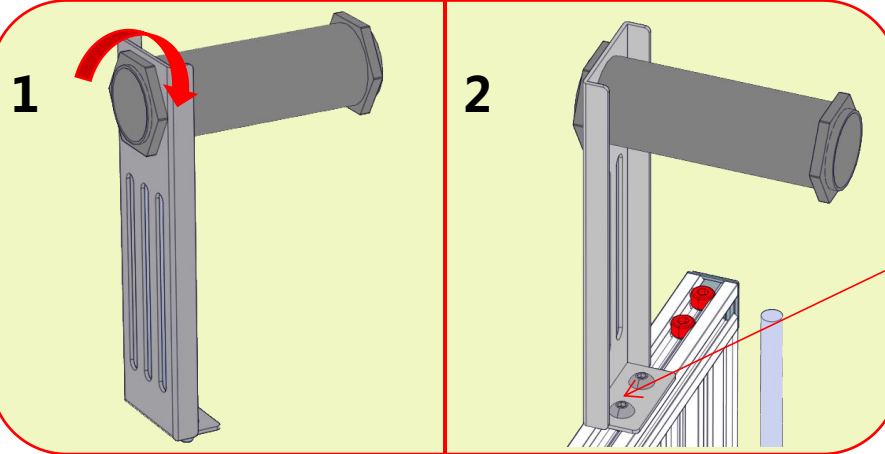
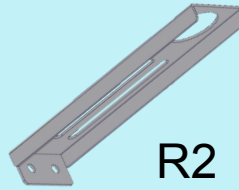
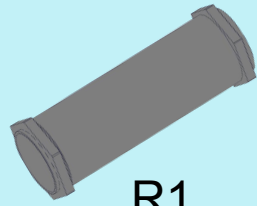

Step 12

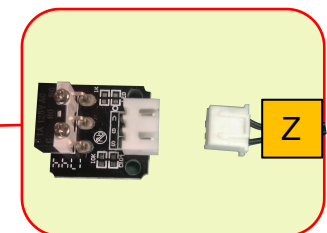
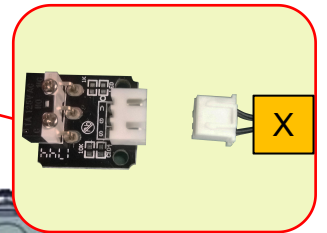
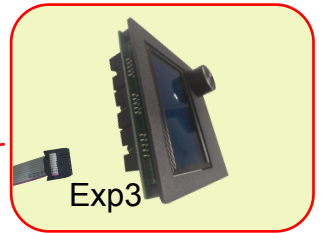
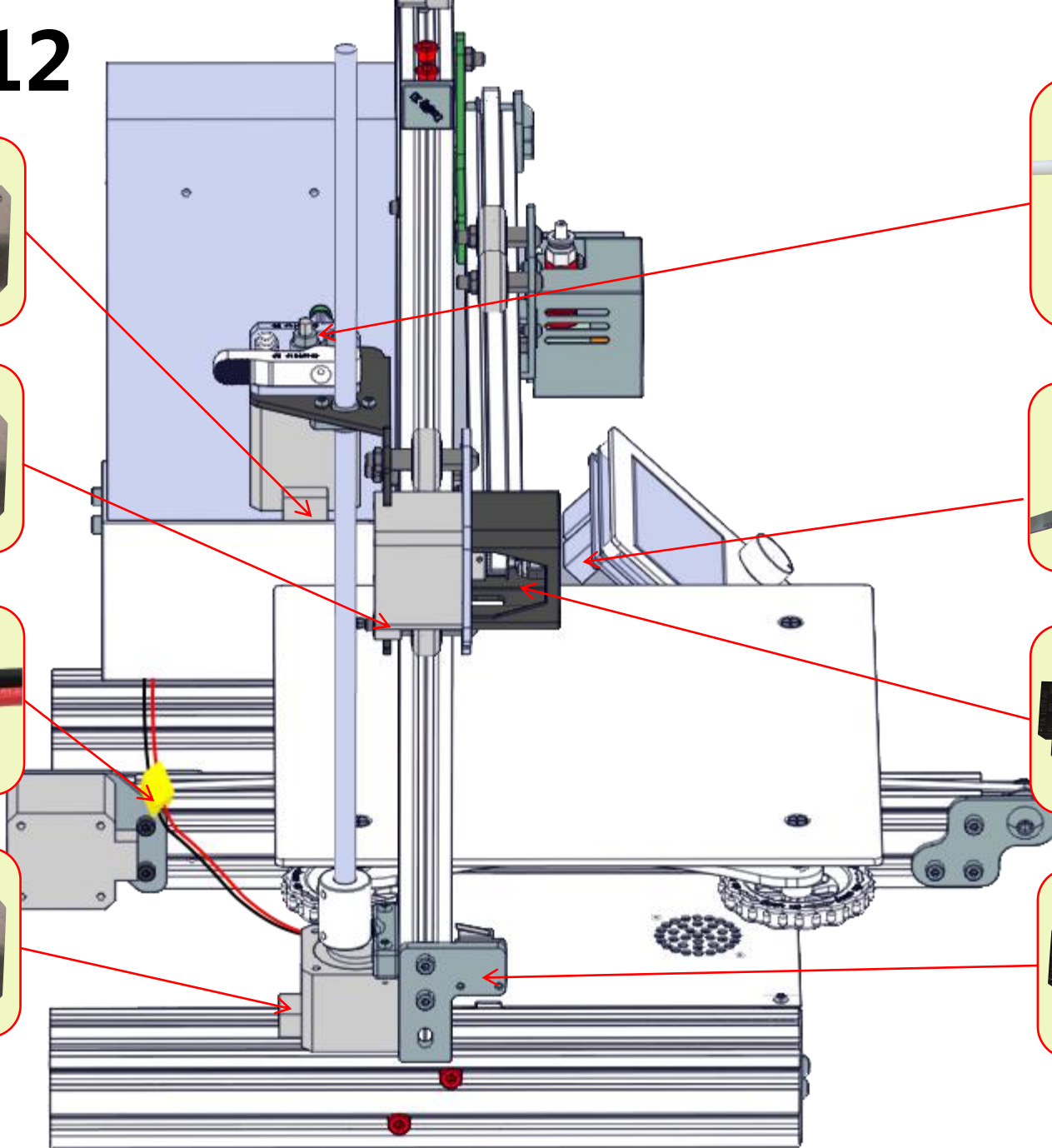
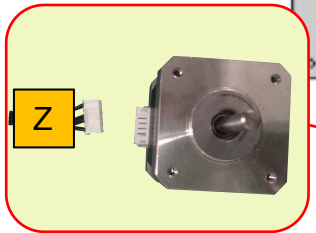
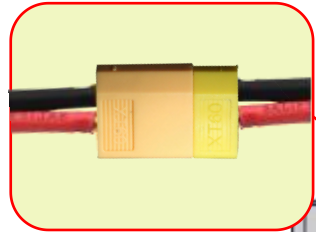
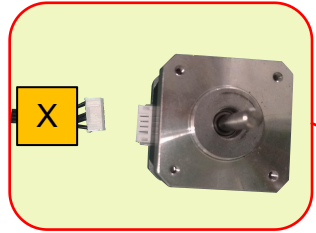
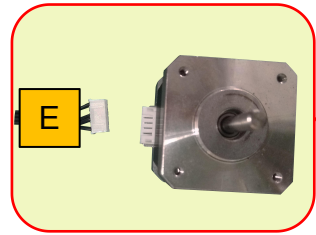



Shenzhen Creality3D Technology CO.,LTD.

Official Website: www.creality3d.com

Company Address: 12F, Building No.3, Jinchengyuan Industrial Area, Huafan Road,
Dalang, Longhua, Shenzhen, Guangdong Province

